

1

2

3

4

5

6

A

A

B

B

C

C

D

D

E

E

F

F

G

G

H

H

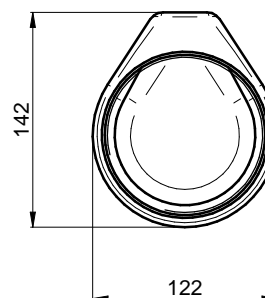
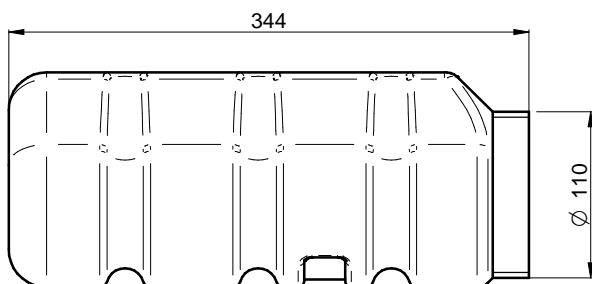
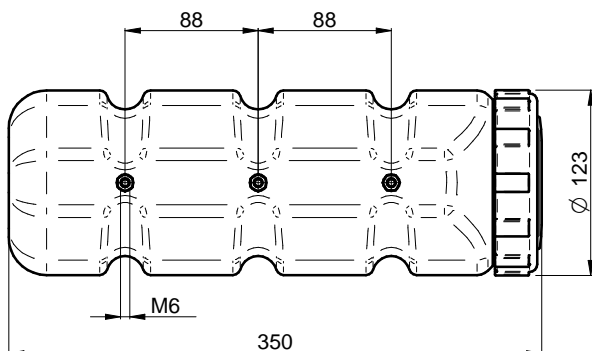
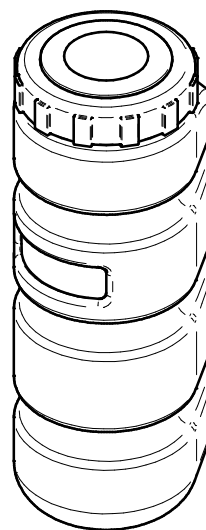
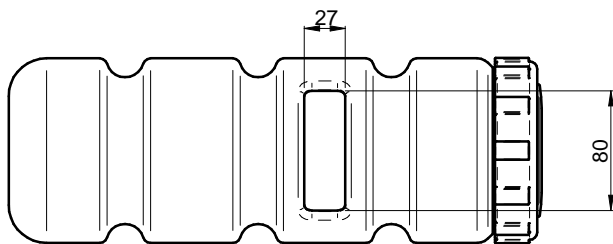

### ACCURACY LINEAR DIMENSIONS

to 6	$\pm 0.1$	from 6 to 30	$\pm 0.2$	from 30 to 120	$\pm 0.3$	from 120 to 315	$\pm 0.5$
from 315 to 1000	$\pm 0.8$	from 1000 to 2000	$\pm 1.2$	from 2000 to 4000	$\pm 2.0$	from 4000	$\pm 3.0$

### ANGULAR DIMENSIONS

from 6	$\pm 1^\circ$	to 6 from 30	$\pm 30'$	from 30 to 120	$\pm 20'$	from 120	$\pm 10'$
--------	---------------	--------------	-----------	----------------	-----------	----------	-----------

REVIEW	N°2	DATE	DESCRIPTION	DRAFTSMAN
	N°1	10/12/2021	Aggiornamento quote	DRAFTSMAN
MATERIAL			TREATMENT	DRAFTSMAN <b>Paolo Livio</b>

### CREATION DATE

19/12/2016

### SET

PORTA DOCUMENTI

DRAWING CODE  
535715001.asm

### DESCRIPTION

PORTA DOCUMENTI TERMOPLASTICO ROLLYX  
[DESCRIPTION OF FINISHED PRODUCT](#)

# LAGO

Lago Accessori srl

via 1°Maggio 20, 35014 Fontaniva (Pd) Italy  
Tel: +39 049 5940932 Fax: +39 049 5940599  
www.lagoaccessori.net info@lagoaccessori.net

SCALE  
**1 : 1**

SHEET  
1/1

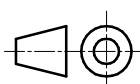

1

6